

Assembly Instruction

**ARC 2 DRAWER DESK
OTARC2DDSK**

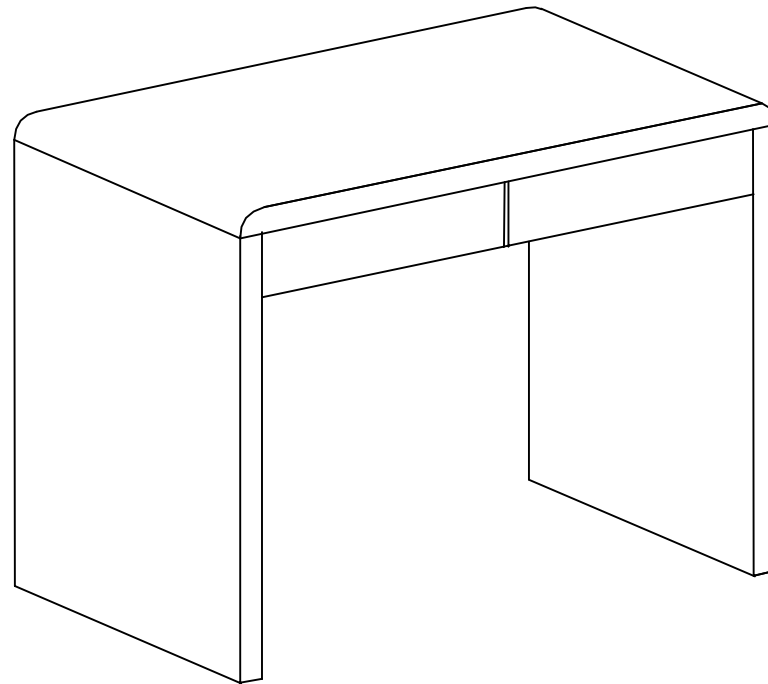

Important
Estimated Assemble Time:45min



MORE THEN 1 PERSON
IS REQUIRED TO SAFELY
ASSEMBLE THE ITEM



HOTLINE

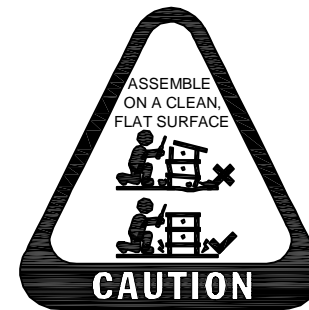

ASSEMBLE ON A CLEAN,
FLAT SURFACE

Tools Required For Assembly

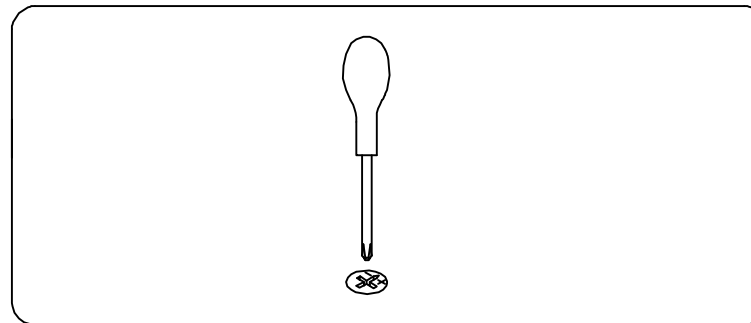

Please check you have all hardware components before assembling.

If you are missing any hardware components from the Hardware List please contact My Zone on

Tel:(03)9310 3011 or Email:hardware@myzone.net.au

Please ensure you have the name of the item,store purchased from,hardware part requited and quantity.

If you are missing any panels from the Panel List Please contact your store of purchase.

Please retain your receipt to validate warranty.Enjoy your new purchase!

Panel List

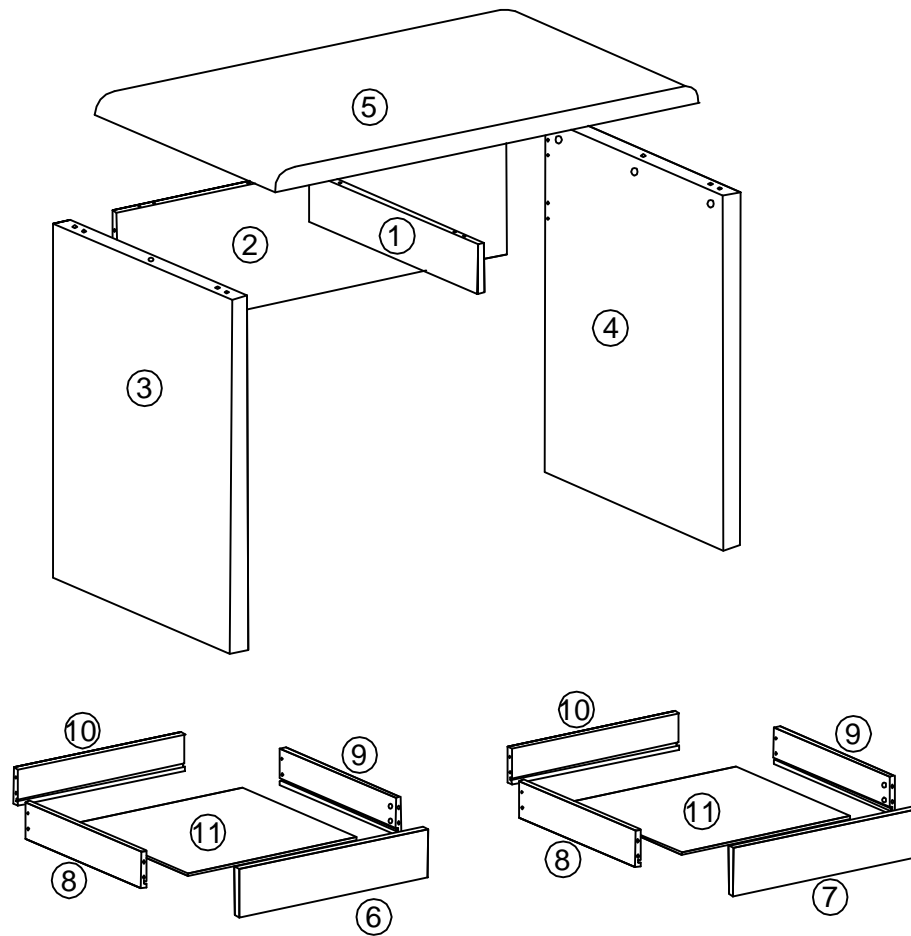

Hardware List

A

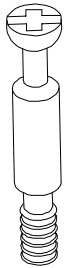

6×35mm
×17pcs

B

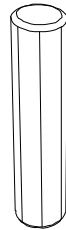

∅8×30mm
×6pcs

C

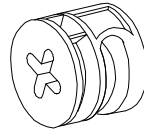

15×12mm
×17pcs

D



6×24mm
×8pcs

E

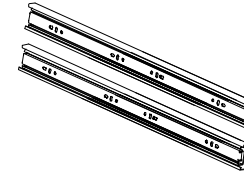

×2sets

F



4×35mm
×8pcs

G



3.5×14mm
×16pcs

H



12×10mm
×8pcs

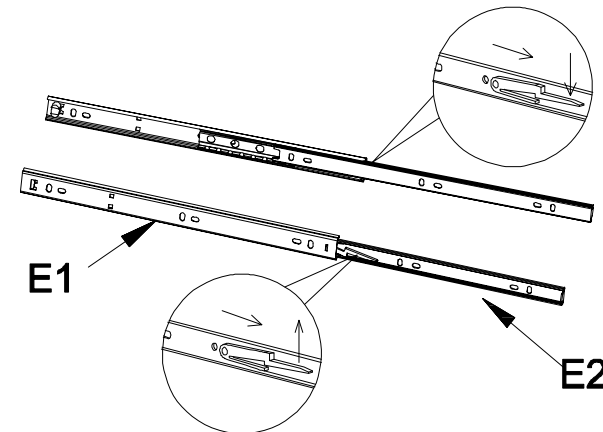

Remark:
Press the plastic slider in the indicated direction to separate drawer runner E1 and E2 before assembling.

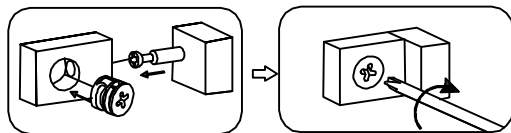

Please hand tighten this with screwdriver!

Step 1

(E2) ×2set



(D) ×8



(H) ×8



(F) ×8



(G) ×8

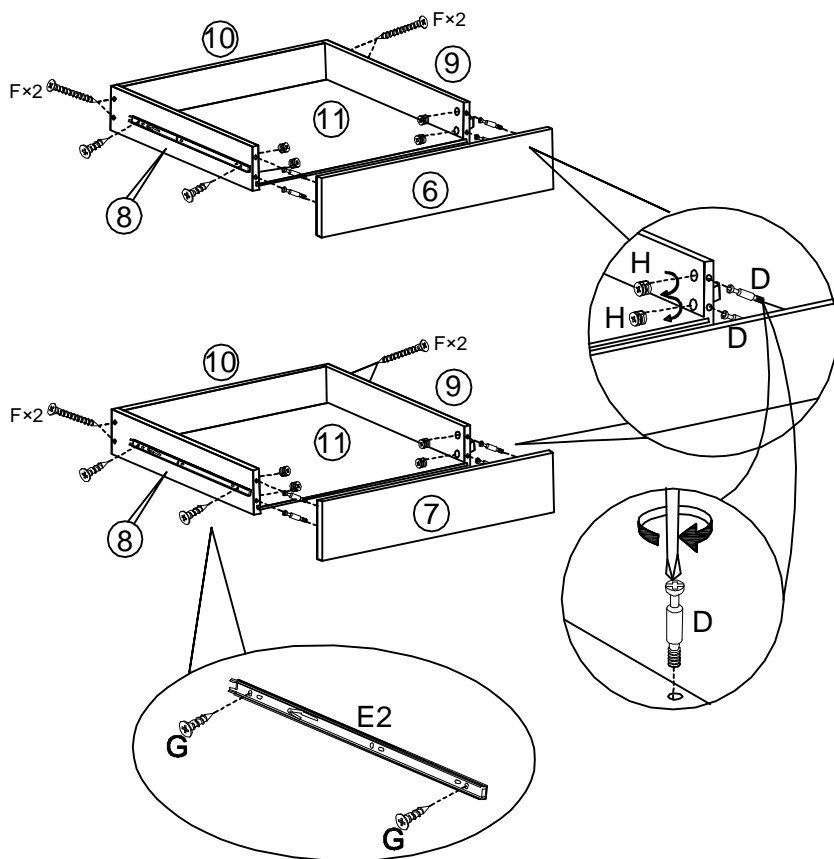

Step 2

(E1) ×1set

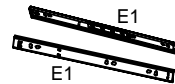

(G) ×4

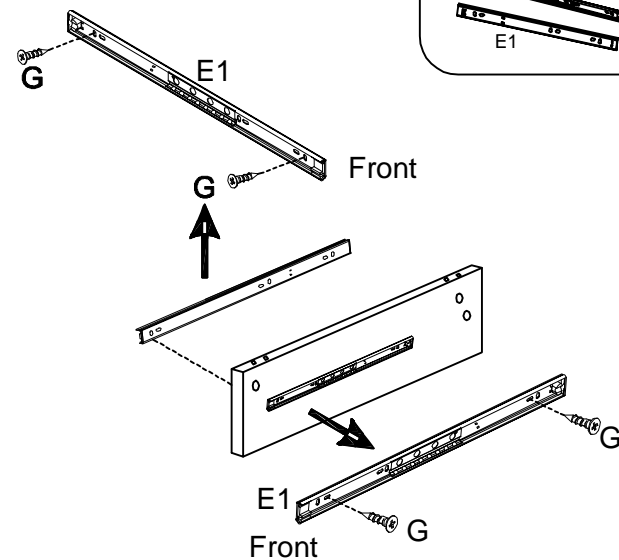

Step 3

(A) ×1



(C) ×1

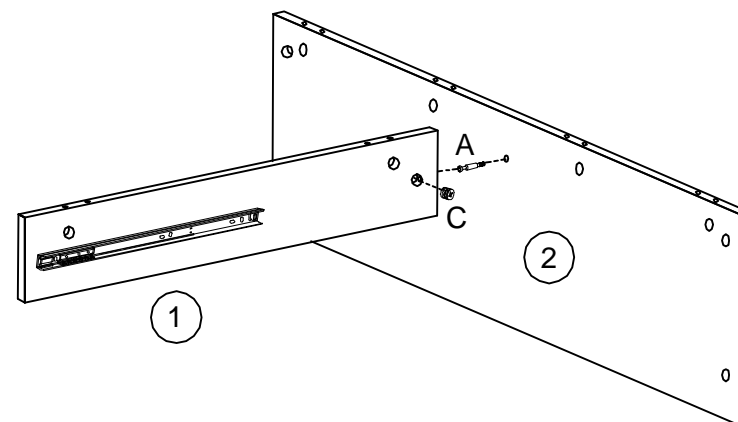

Step 4

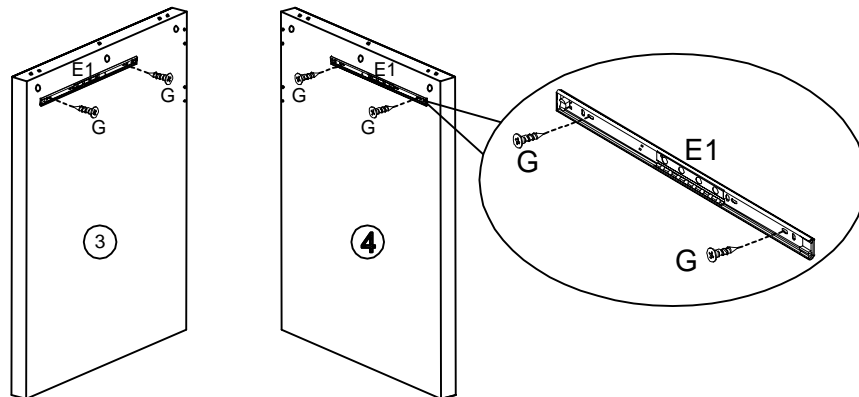
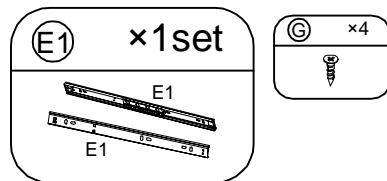

Step 5

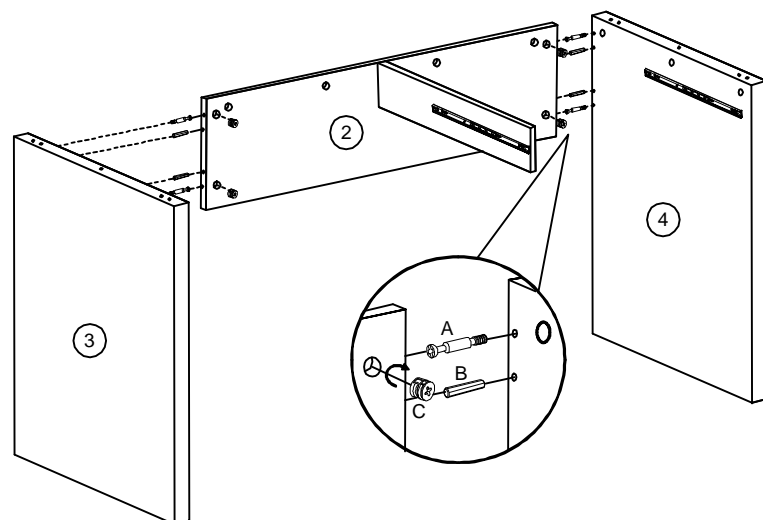
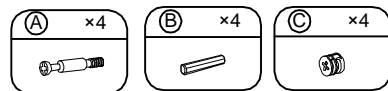

Step 6

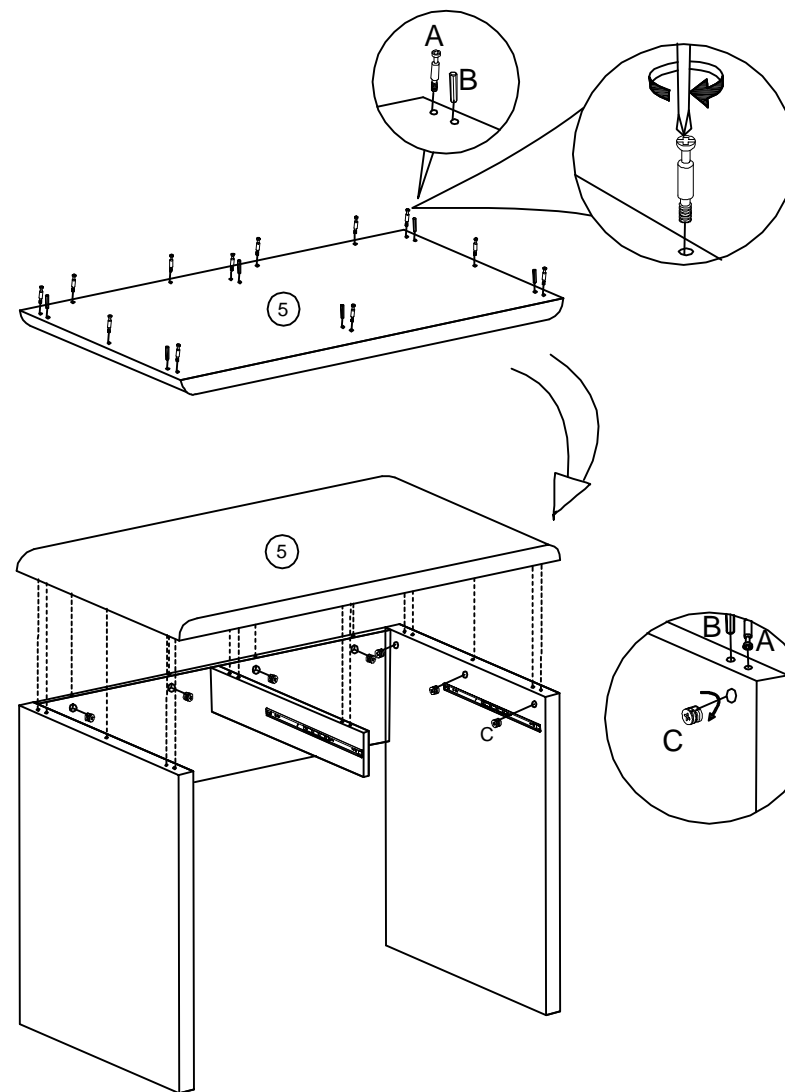
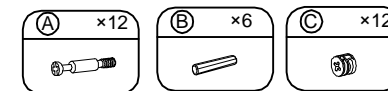

Step 7

If you want to remove drawer, simultaneously press plastic levers on both sides and pull drawer outward.

Maximum Load Capacity:
Desk top: 50kg
Drawer: 5kg

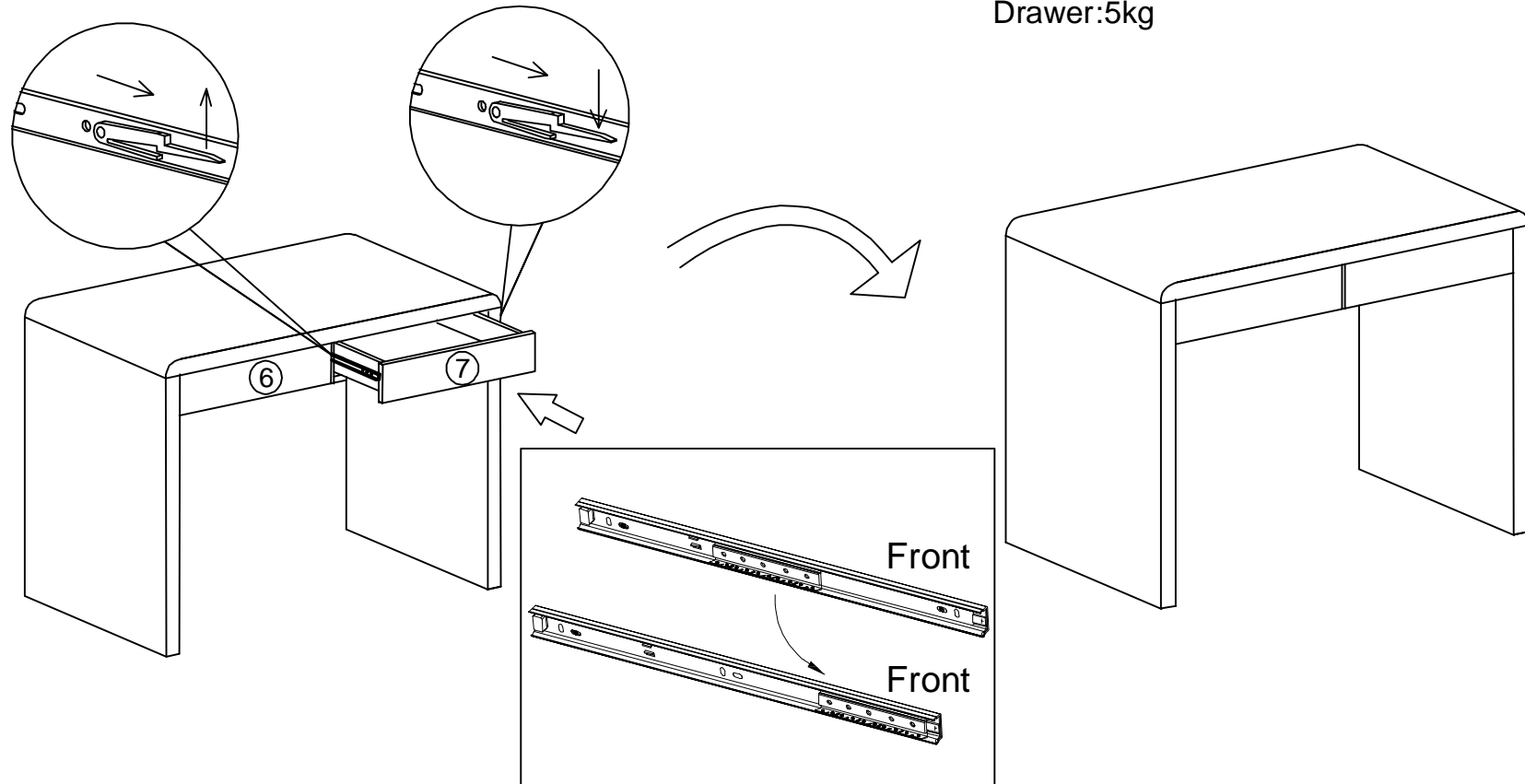

Note: Move the sliding part as shown above to the front end on both sides before inserting the drawer. This will assist for easier assembly

Your ARC 2 DRAWER DESK is now complete and ready for use.

Officeworks Superstores Pty Ltd. | 236-262 East Boundary Road | East Bentleigh | 3165 | AUSTRALIA.